

# contaflexactiv Metal Waterstops



Precast walls with a thickness of > 14 cm can be waterproofed against hydrostatic pressure with an internal sealing system. In this case the compaction of the concrete has to be carried out with great care. The installation of a system with active waterproofing is highly recommended. Contaflexactiv-Butt Joint Units were specially designed for the application in precast walls and meet the high demands for effective waterproofing and easy handling during installation.



**perfect!**  
due to active  
seal effect

- double security** ✓
- easy installation** ✓
- sealed lap joints** ✓
- active overlaps** ✓

The coating of the metal waterstops consists of highly swelling Volclay-Bentonite. contaflexactiv-Metal Waterstops are Building Inspectorate tested.

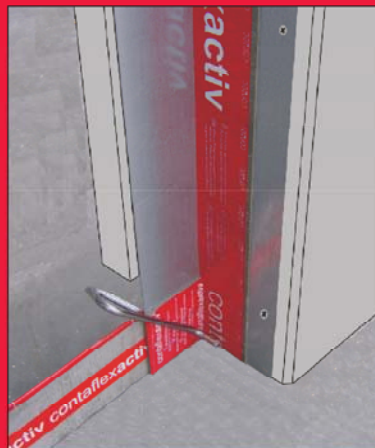

## Technical Details

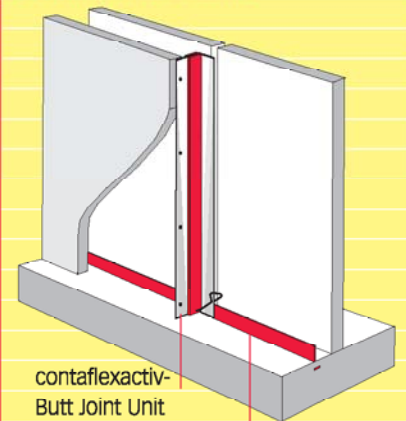

contaflexactiv-  
Butt Joint Unit

contaflexactiv-Metal Waterstop

Protective film to prevent premature swelling when exposed to rain

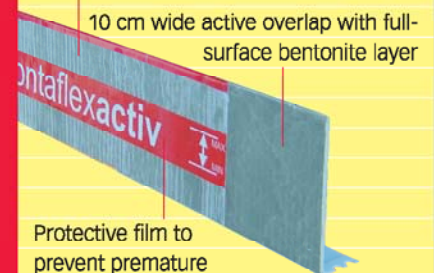

10 cm wide active overlap with full-surface bentonite layer

Protective film to prevent premature swelling in the case of surface water on the base slab. Top edge base slab to be between the marks.

Favourable conditions and straight placement allow proper compaction in the area of the base slab to wall joint.

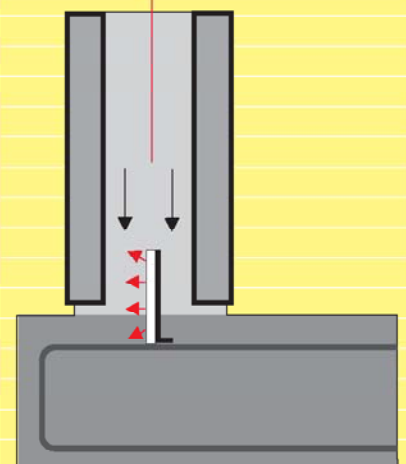

# Internal waterproofing of precast walls



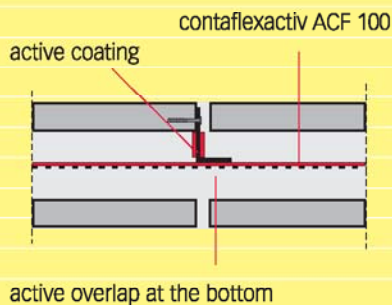

## Butt joint unit

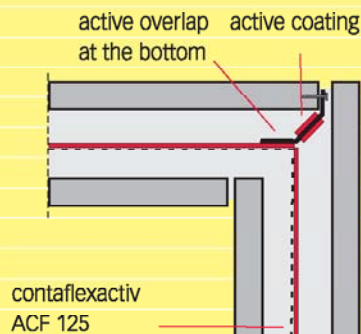

## Angle joint unit

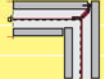
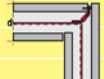

## System with individual components

	<b>CFS-A 250 Butt Joint Unit</b> with active coating for precast walls d = 25 cm, L = 1.50 m	21314110	1 box = 6 units
	<b>CFS-A 300 Butt Joint Unit</b> with active coating for precast walls d = 30 cm, L = 1.50 m	21314120	1 box = 6 units
	<b>CFE-A 250 Angle Joint Unit</b> with active coating for precast walls d = 25 cm, L = 1.50 m	21314210	1 box = 6 units
	<b>CFE-A 300 Angle Joint Unit</b> with active coating for precast walls d = 30 cm, L = 1.50 m	21314220	1 box = 6 units
	<b>ACF 100 plus Metal Waterstop</b> with active coating and base b = 10.0 cm, L = 2.25 m	12241100	1 box = 10 units
	<b>ACF 125 plus Metal Waterstop</b> with active coating and base b = 12.5 cm, L = 2.25 m	12242100	1 box = 10 units



The metal waterstops are installed by adjusting the height in the overlap area and secured with 2 fixing clips. The lap area is sealed by the full-surface bentonite layer of the active overlap.

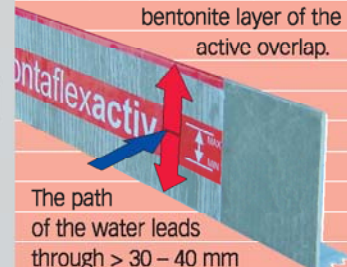

The path of the water leads through > 30 – 40 mm of bentonite. The seal effect of a bentonite layer of this thickness is comparable to that of 30 – 40 cm of impervious watertight concrete.

Permeability coefficient:  
Bentonite:  $10^{-11}$  m/sec  
Watertight concrete:  $10^{-9}$  m/sec

## Specifications

\_\_\_\_\_ m of bentonite coated metal waterstop units for vertical joints in precast walls, to be supplied and installed as waterproofing against hydrostatic pressure according to the manufacturer's installation guidelines.  
Wall width d = \_\_\_\_\_ cm

**Make: contaflexactiv-Metal Waterstop**

\_\_\_\_\_ m of bentonite coated metal waterstop units for the horizontal base slab to wall joint, to be supplied and installed as waterproofing against hydrostatic pressure according to the manufacturer's installation guidelines.

**Make: contaflexactiv-Metal Waterstop ACF 125**