

**Expansion joint waterstops, internal, black, Standard Specification with AbP**

PVC-P Standard Specification	total width	width of expansion part	thickness of expansion part	comparable profiles according to DIN 18541
D 10	100	40	3,0	
D 15	150	50	3,0	
D 19	190	75	3,0	D 190*
D 24	240	85	4,0	D 240
D 32	320	110	5,0	D 320
D 40	400	125	5,5	D 400
D 50	500	160	6,0	D 500
D 25/6	250	120	6,0	D 250/6
D 32/6	320	170	6,0	D 320/6
D 25/9	250	120	9,0	D 250/9
D 32/9	320	120	9,0	D 320/9
SFD 24	240	85	4,0	SFD 240
SFD 32	320	110	4,5	SFD 320

\* DIN 18541, Teil 2

D 250/6

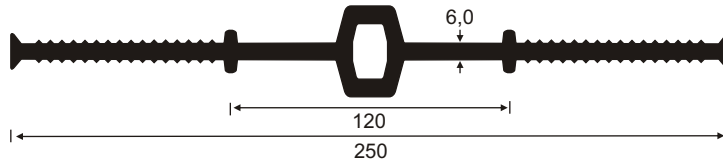

D 320/6

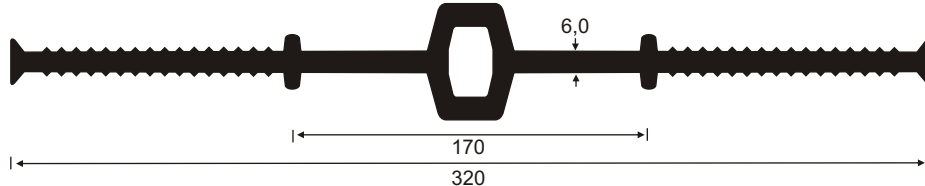

D 250/9

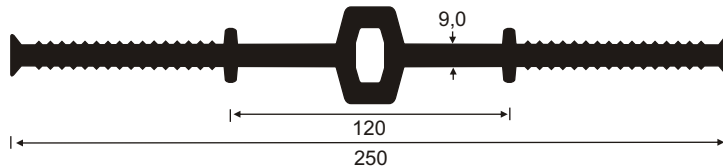

D 320/9

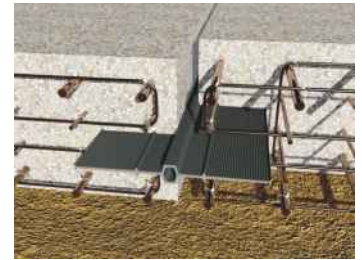
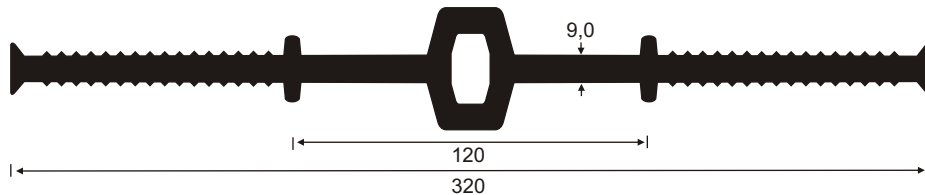

**Expansion joint waterstops, internal,  
with extruded reinforcement and  
fixing loops, black, LECOTRIL DIN 18541**

SFD 240

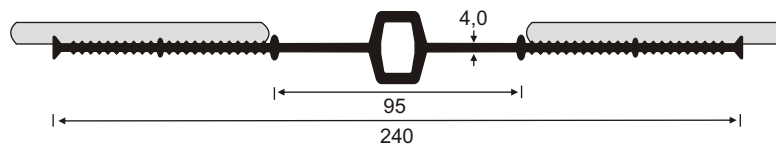

SFD 320

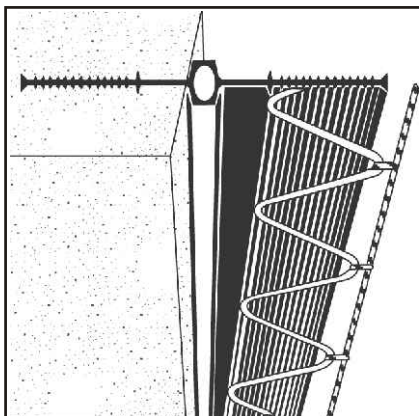
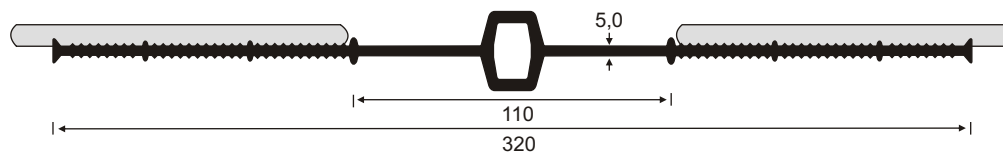

The expansion joint waterstops with fixing loops are reinforced one - sided with harder adjusted PVC - P cords and have fixing loops on both edges of the waterstop.

The PVC - loops consist of high impact resisting harder adjusted PVC - P. They have a thickness of 6 mm and stabilise the waterstop. The loops are arranged outside the expansion part, which keeps the expansion part free.

- reliable fastening
- quick installation
- high inherent stability
- good welding quality